

How to remove and reassemble the cutters for
cleaning the SensoTouch shaver

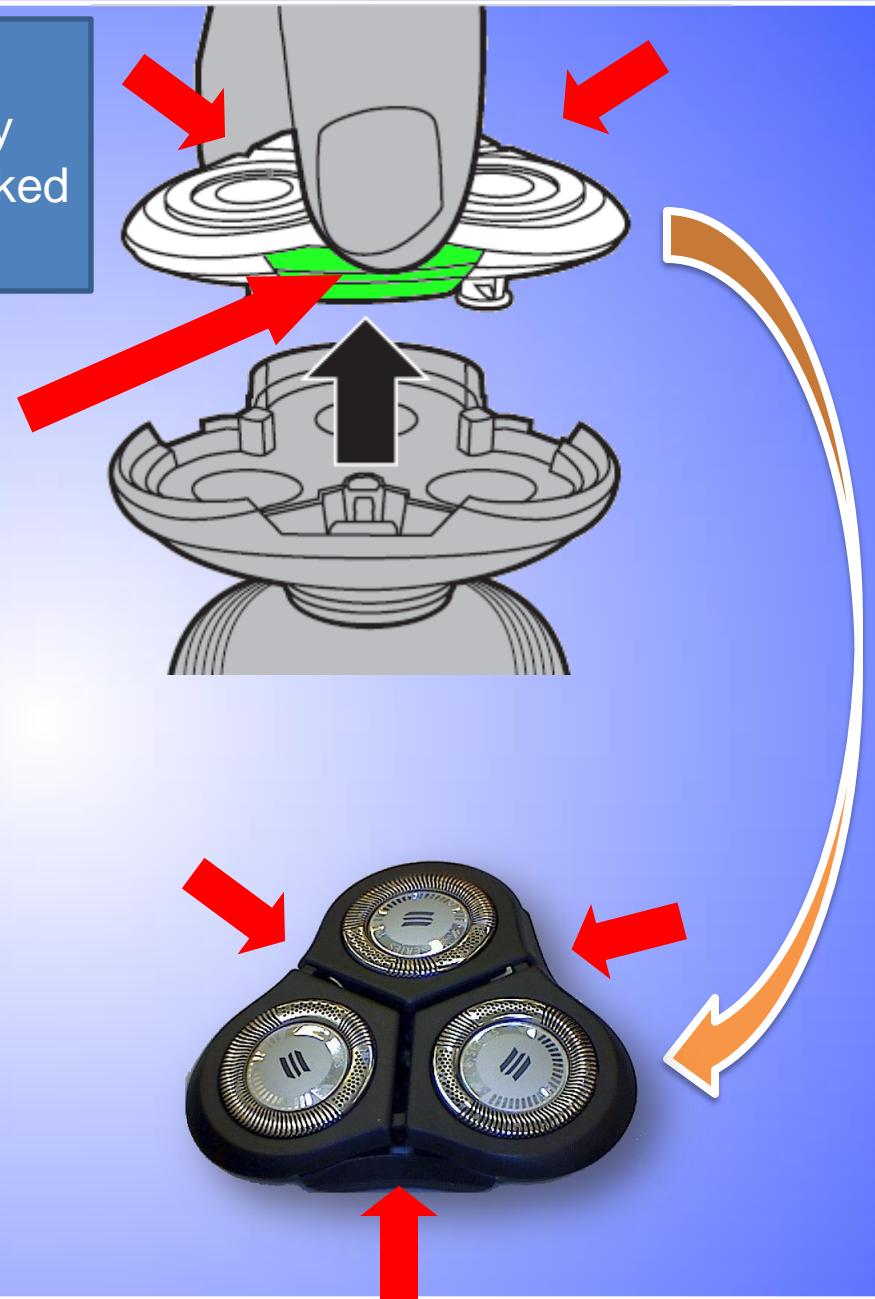

1

Pull the top part of the shaving unit from the shaver by pressing slightly on the three sides of the head marked with pointer



REMOVE GREEN FRAME AND CUTTERS

<http://youtu.be/ggUJhftv0hs> **You Tube**

1

1

Slide the green frame in the direction of the arrow

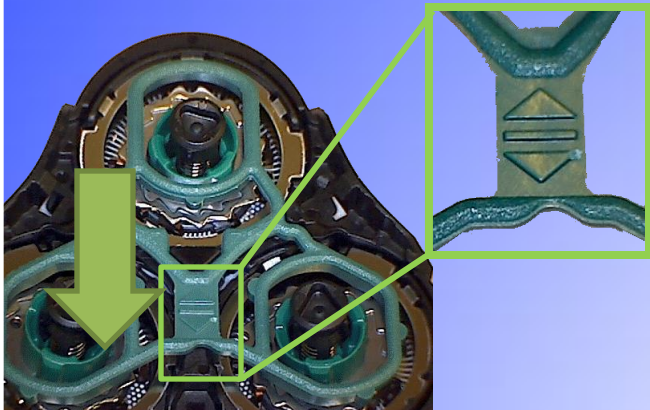

2

2

Lift the green frame from the shaving unit

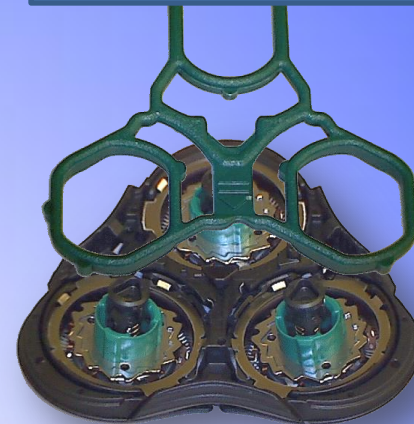

3

3

Take the cutters from the guards – one by one!

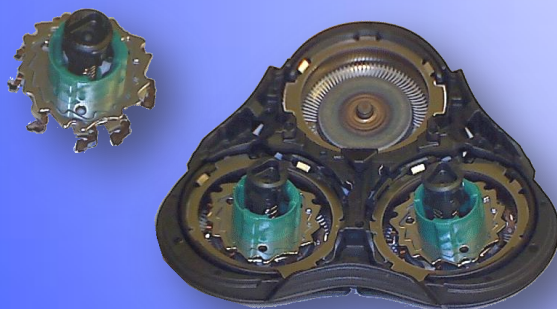

4

4

Remember which cutter belongs to which guard

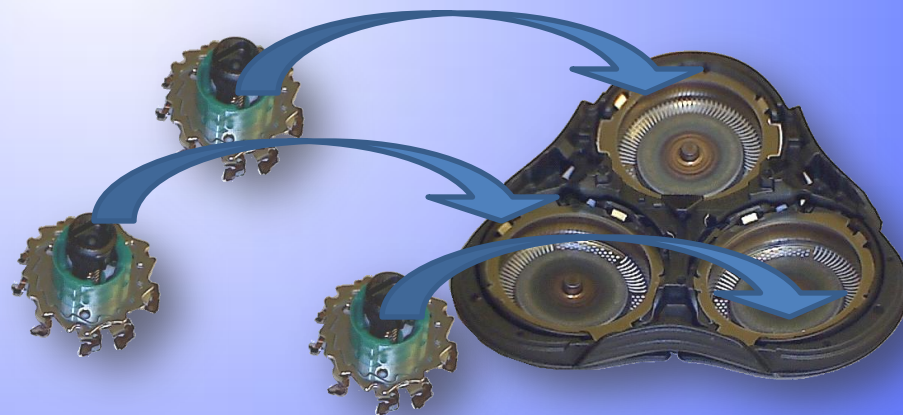

5

The guards (caps) cannot be removed!!!

REPLACE CUTTERS and FRAME

<http://youtu.be/1HCB8eWf3EM> **You Tube**

1

1

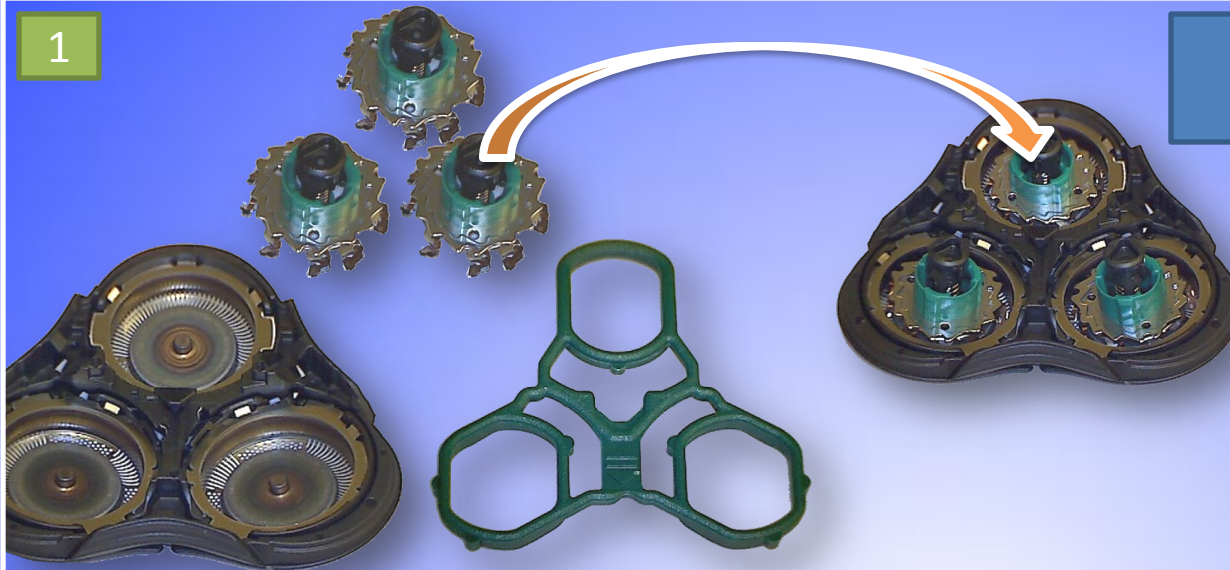

Place cutters back in shaving unit, green part facing up

2

3

2

Place green frame over cutters -
NEXT slide for details

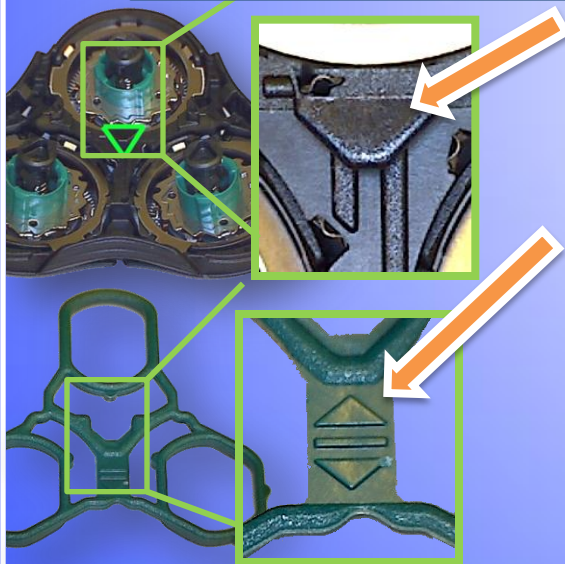

4

5

3

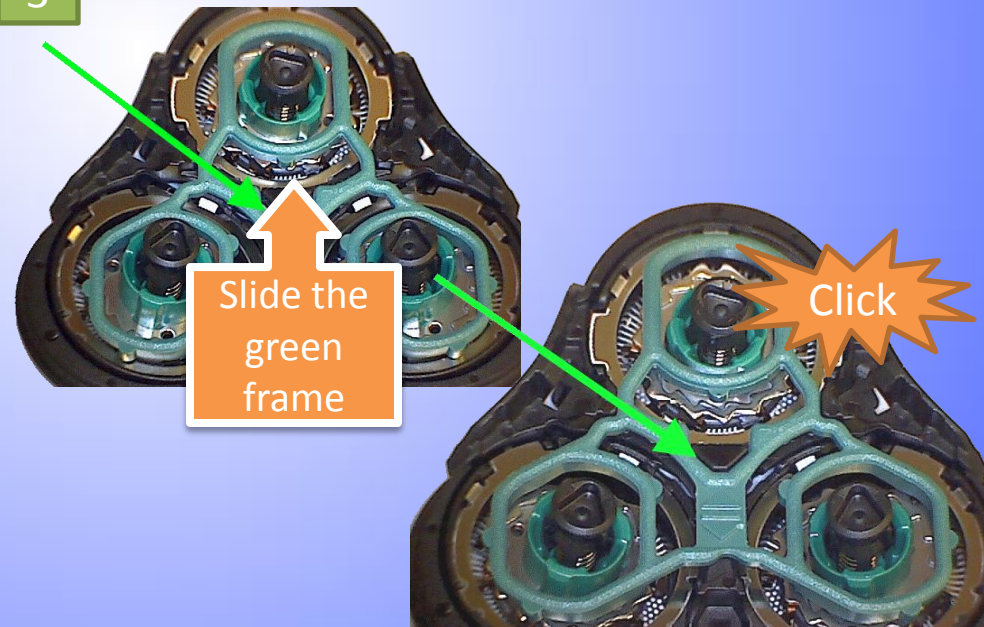

1

Place green frame over cutters. Pay attention to right orientation!

- 1) Black triangle in middle of shaving unit must be oriented with its point facing towards you
- 2) Green frame must be oriented:
 - 1) With arrows visible
 - 2) Turn the frame until the orientation is correct

2

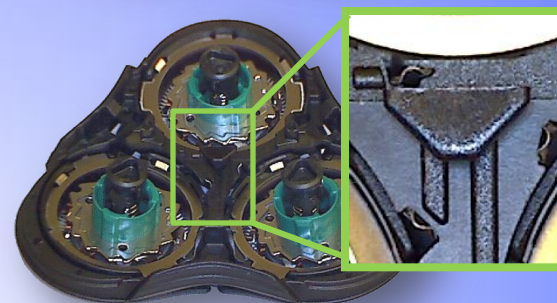
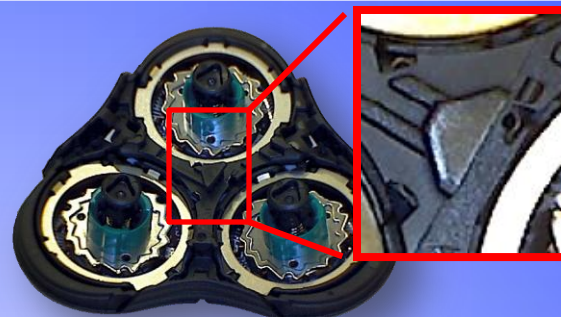

3

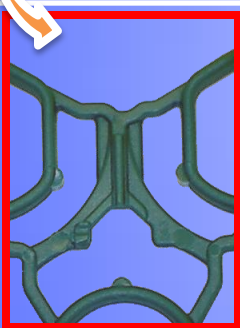

4

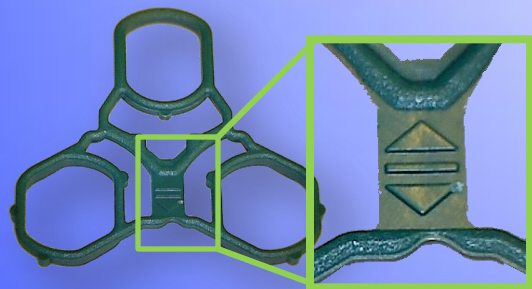

5

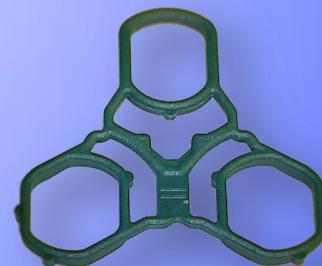

PLACE SHAVING UNIT ON SHAVER

1

Reattach the shaving head holder to the bottom of the shaving unit ('click')

