

Register your product and get support at
www.philips.com/welcome

RQ1100 series



PHILIPS



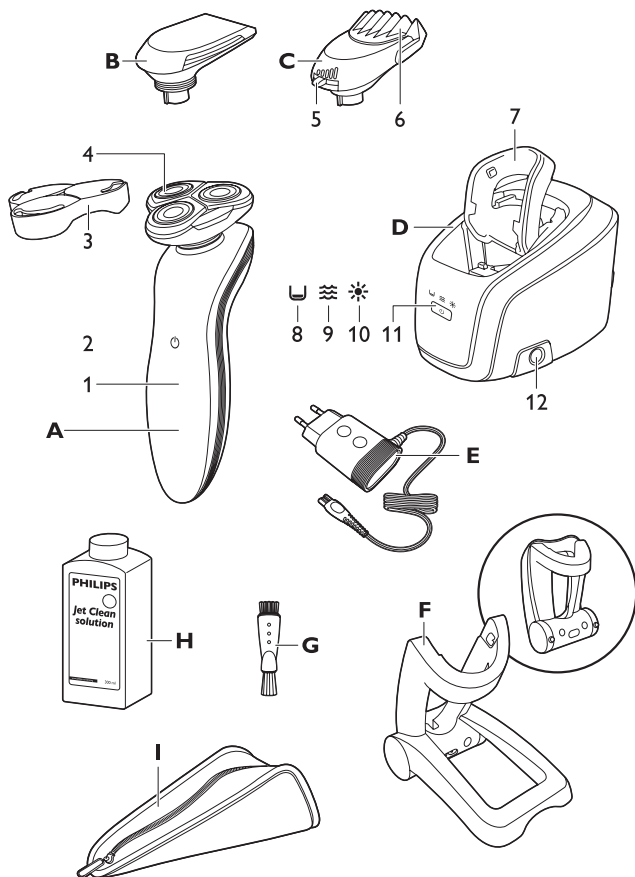



RQ119x, RQ118x, RQ117x, RQ116x, RQ115x, RQ114x, RQ113x

ENGLISH 6

简体中文 35

Introduction

Congratulations on your purchase and welcome to Philips! To fully benefit from the support that Philips offers, register your product at www.philips.com/welcome.

Please read this user manual, as it contains information about the features of this shaver as well as some tips to make shaving easier and more enjoyable.

General description (Fig. 1)

- A Shaver
 - 1 Display
 - 2 Shaver on/off button
 - 3 Protection cap
 - 4 RQ11 Shaving unit
- B CRP331 Trimmer (RQ118x/RQ116x/RQ115x only)
- C RQ111 Beard Styler attachment (RQ1195/RQ1185/RQ1175 only)
 - 1 Hair length selector
 - 2 Comb of Beard Styler attachment
- D Jet Clean System (RQ1195CC/RQ1185CC/RQ1180CC/RQ1175CC only)
 - 1 Shaver holder
 - 2 'Cleaning chamber empty' symbol
 - 3 Cleaning symbol
 - 4 Drying symbol
 - 5 Jet Clean System on/off button
 - 6 Cleaning chamber release button
- E Adapter
- F Charger
- G Cleaning brush
- H HQ200 Cleaning fluid (specific types only)
- I Pouch (specific types only)

Important

Read this user manual carefully before you use the shaver and the Jet Clean System and save it for future reference.

Note: In this user manual the term ‘appliances’ refers to the shaver and the Jet Clean System. If your shaver does not come with a Jet Clean System, it refers to the shaver only.

General**Danger**

- Make sure the adapter does not get wet.

Warning

- The adapter contains a transformer. Do not cut off the adapter to replace it with another plug, as this causes a hazardous situation.
- These appliances are not intended for use by persons (including children) with reduced physical, sensory or mental capabilities, or lack of experience and knowledge, unless they have been given supervision or instruction concerning use of these appliances by a person responsible for their safety.
- Children should be supervised to ensure that they do not play with the shaver and the Jet Clean System.
- Be careful with hot water when you clean the appliances. Always check if the water is not too hot, to prevent your hands from getting burnt.

Caution

- Never immerse the Jet Clean System and the charger in water nor rinse them under the tap.
- The appliances and accessories are not dishwasher-proof.

- Always place and use the appliances on a surface that is fluid-resistant.
- Use, charge and store the shaver at a temperature between 5°C and 35°C.
- Only use the accessories supplied with this shaver or that have been specifically developed for this shaver.
- If the adapter or any of the other accessories is damaged, always have it replaced with one of the original type in order to avoid a hazard.
- The adapter transforms 100-240 volts to a safe low voltage of less than 24 volts.
- Do not use the appliances and accessories if they are damaged.
- Water may leak from the socket at the bottom of the shaver when you rinse it. This is normal and not dangerous because all electronics are enclosed in a sealed power unit inside the shaver.

Jet Clean system (specific types only)

Caution

- Only use the Jet Clean System with the original HQ200 cleaning fluid.
- Always place and use the Jet Clean System on a stable, level and horizontal fluid-resistant surface to prevent leakage.
- Never immerse the Jet Clean System in water.
- Empty the cleaning chamber and clean it thoroughly by rinsing it with hot tap water every 15 days.
- The Jet Clean System thoroughly cleans but does not disinfect your shaver; therefore do not share the shaver with others.
- The cleaning chamber of the Jet Clean System is not dishwasher-proof.
- When the Jet Clean System is ready for use, do not move it to prevent leakage of cleaning fluid.

Beard Styler attachment (specific types only)

Caution

- Only use the Beard Styler attachment to trim facial hair (beard, moustache and sideburns). Do not use it to trim body parts below the neckline.
- Only use the Beard Styler attachment in combination with the following shaver types: RQ12xx, RQ11xx, RQ10xx.
- The Beard Styler attachment is not dishwasher-proof.

Compliance with standards



- This shaver complies with the internationally approved safety regulations and can be safely used in the bath or shower and cleaned under the tap.
- These Philips appliances comply with all standards regarding electromagnetic fields (EMF). If handled properly and according to the instructions in this user manual, the appliances are safe to use based on scientific evidence available today.

The display

Note: *If there is a protective foil on the display, remove it before you use the shaver for the first time.*

The various shaver types have different displays, which are shown in the figures below.

10 ENGLISH

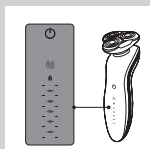

- RQ1195/RQ1180/RQ1175

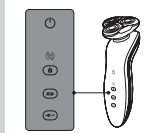

- RQ1185/RQ1160

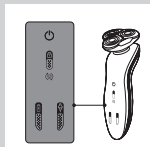

- RQ1155/RQ1151/RQ1150/RQ1145/RQ1141/
RQ1131

Charging

- Charging takes approx. 1 hour.

RQ1195/RQ1180/RQ1175

- When the shaver is charging, first the bottom charging light flashes, then the second charging light, and so on until the shaver is fully charged.
- Quick charge: When the shaver contains enough energy for one shave, the bottom charging light alternately flashes orange and white.

RQ1185/RQ1160/RQ115x/RQ114x/RQ113x

Note: The displays of the various shaver types look different, but work in the same way.

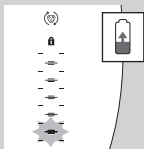

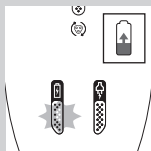

- When the shaver is charging, first the plug symbol and the battery symbol flash alternately. After some time, the plug symbol goes out and the battery symbol continues to flash until the shaver is fully charged.
- Quick charge: When the shaver contains enough energy for one shave, the alternate flashing of the plug symbol and battery symbol stops and only the battery symbol flashes.

Battery fully charged

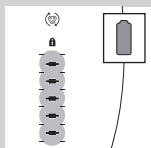

RQ1195/RQ1180/RQ1175

- When the battery is fully charged, all charging lights light up continuously. After approx. 30 minutes, the display automatically switches off again.

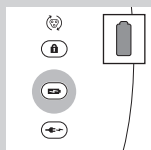

RQ1185/RQ1160/RQ115x/RQ114x/RQ113x

Note: The displays of the various shaver types look different, but work in the same way.

- When the battery is fully charged, the battery symbol lights up continuously. After approx. 30 minutes, the display automatically switches off again.

Battery low

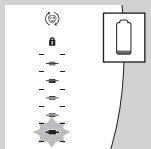

RQ1195/RQ1180/RQ1175

- When the battery is almost empty (when there are only 5 or fewer shaving minutes left), the bottom charging light flashes orange.
- When you switch off the shaver, the bottom charging light continues to flash for a few seconds.

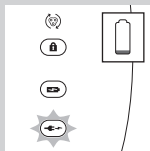

RQ1185/RQ1160/RQ115x/RQ114x/RQ113x

Note: The displays of the various shaver types look different, but work in the same way.

- When the battery is almost empty (when there are only 5 or fewer shaving minutes left), the plug symbol flashes.
- When you switch off the shaver, the plug symbol continues to flash for a few seconds.

Remaining battery capacity

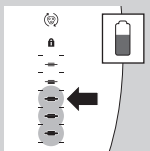

RQ1195/RQ1180/RQ1175

- The remaining battery capacity is indicated by the number of charging lights that are on.

Travel lock

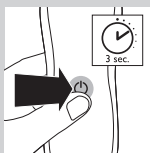

You can lock the shaver when you are going to travel. The travel lock prevents the shaver from being switched on by accident.

Activating the travel lock

- 1 Press the on/off button for 3 seconds to enter the travel lock mode.

- The lock symbol lights up on the display.

Note: The displays of the various shaver types look different, but show the same symbol.

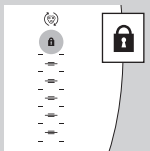

Deactivating the travel lock

- 1 Press the on/off button for 3 seconds.
- The motor starts running to indicate that the travel lock has been deactivated.
- The shaver is now ready for use again.

Note: When you place the shaver in the plugged-in charger or Jet Clean System, the travel lock is automatically deactivated.

Replace shaving head holder

Note: The displays of the various shaver types look different, but show the same symbol.

For maximum shaving performance, we advise you to replace the shaving head holder every two years.

- To remind you to replace the shaving head holder, the appliance is equipped with a replacement reminder which is activated automatically after approx. two years. The replacement reminder is repeated at 9 successive shaves or until you reset the shaver.

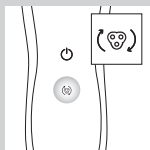

Charging

Charging takes approx. 1 hour.

RQ1195/RQ1185/RQ1180/RQ1175/RQ1160/

RQ1155: A fully charged shaver has a shaving time of up to 50 minutes or 15 days.

RQ1151/RQ1150/RQ1145: A fully charged shaver has a shaving time of up to 45 minutes or 13 days.

RQ1141/RQ1131: A fully charged shaver has a shaving time of up to 40 minutes or 12 days.

Charge the shaver before you use it for the first time and when the display indicates that the battery is almost empty (see section 'Battery low' in chapter 'The display').

Quick charge

After the shaver has charged for 5 minutes, it contains enough energy for one shave.

Charging in the charger

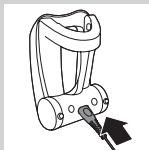

- 1** Insert the small plug into the charger.

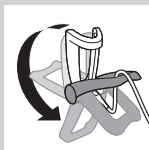

- 2** Unfold the charger ('click').

- 3** Put the adapter in the wall socket.

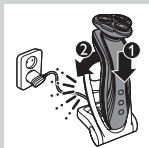

- 4** Put the shaver in the charger (1) and press it backwards until it locks in place (2).

- ▶ The display shows that the shaver is charging (see section 'Charging' in chapter 'The display').

Charging in the Jet Clean System (specific types only)

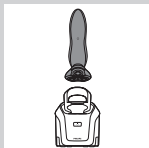

- 1** Put the small plug in the Jet Clean System.

- 2** Put the adapter in the wall socket.

- 3** Hold the shaver upside down above the holder with the back of the shaver pointing towards the holder.

Note: RQ1195/RQ1180/RQ1175: when you turn the shaver upside down, the battery indication on the display is also turned upside down so you can still see to what level the battery is charged.

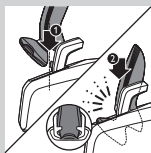

- 4** Place the shaver body in the holder behind the two clips (1) and press it down until it locks into place (2).

Note: The shaver cannot be placed in the Jet Clean System when the protection cap is on the shaving unit or when the trimmer is placed on the shaver.

- The display shows that the shaver is charging (see chapter 'The display').

Using the shaver

Shaving

Skin adaptation period

Your first shaves may not bring you the result you expect and your skin may even become slightly irritated. This is normal. Your skin and beard need time to adapt to any new shaving system.

We advise you to shave regularly (at least 3 times a week) for a period of 3 weeks to allow your skin to adapt to the new shaver. During this period, use your new electric shaver exclusively and do not use other shaving methods. If you use different shaving methods, it is more difficult for your skin to adapt to the new shaving system.

- 1** Press the on/off button once to switch on the shaver.
- RQ1195/RQ1180/RQ1175: The display lights up for a few seconds.



- 2** Move the shaving heads over your skin in circular movements.

- Do not make straight movements.

- 3** Press the on/off button once to switch off the shaver.

► **RQ1195/RQ1180/RQ1175:** The display lights up for a few seconds and then shows the remaining battery capacity.

Wet shaving

You can also use this shaver on a wet face with shaving foam or shaving gel.

To shave with shaving foam or shaving gel, follow the steps below:

- 1** Apply some water to your skin.
- 2** Apply shaving foam or shaving gel to your skin.
- 3** Rinse the shaving unit under the tap to ensure that the shaving unit glides smoothly over your skin.
- 4** Press the on/off button once to switch on the shaver.
- 5** Move the shaving heads over your skin in circular movements.

Note: Rinse the shaver under the tap regularly to ensure that it continues to glide smoothly over your skin.

- 6** Dry your face and thoroughly clean the shaver after use (see chapter 'Cleaning and maintenance').

Note: Make sure you rinse all foam or shaving gel off the shaver.

Using the trimmer (specific types only)

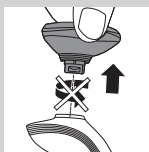

You can use the trimmer to groom your sideburns and moustache.

- 1** Pull the shaving unit straight off the shaver.

Note: Do not twist the shaving unit while you pull it off the shaver.

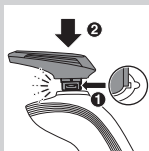

- 2** Insert the lug of the trimmer into the slot in the top of the shaver (1). Then press down the trimmer (2) to attach it to the shaver ('click').

- 3** Press the on/off button once to switch on the trimmer.

► RQ1180: The display lights up for a few seconds.

- 4** You can now start trimming.

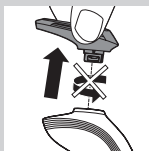

- 5** Press the on/off button once to switch off the trimmer.

► RQ1180: The display lights up for a few seconds to show the remaining battery capacity.

- 6** Pull the trimmer straight off the shaver.

Note: Do not twist the trimming unit while you pull it off the shaver.



- 7** Insert the lug of the shaving unit into the slot in the top of the shaver (1). Then press down the shaving unit (2) to attach it to the shaver ('click').

Using the Beard Styler attachment (specific types only)

Note: Only use the Beard Styler attachment to trim facial hair (beard, moustache and sideburns). Do not use it to trim body parts below the neckline.

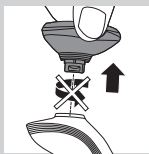

- 1** Make sure the shaver is switched off.
- 2** Pull the shaving unit straight off the shaver.

Note: Do not twist the shaving unit while you pull it off the shaver.

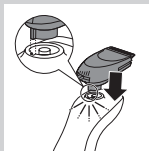

- 3** Insert the lug of the Beard Styler attachment into the slot in the top of the shaver (1). Then press down the Beard Styler attachment (2) to attach it to the shaver ('click').

Using the Beard Styler attachment with comb

You can use the Beard Styler attachment with the comb attached to style your beard at one fixed setting, but also at different length settings. The hair length settings on the Beard Styler attachment correspond to the remaining hair length after cutting and range from 1 to 5mm.

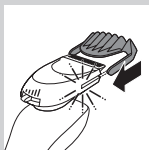

- 1** Slide the comb straight into the guiding grooves on both sides of the Beard Styler attachment ('click').
- 2** Press the length selector (1) and then push it to the left or right (2) to select the desired hair length setting.

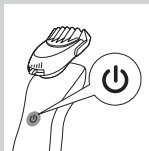
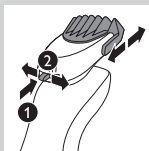

- 3** Press the on/off button on the shaver to switch it on.

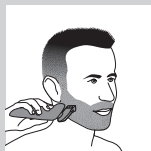

4 You can now start styling your beard.

Using the Beard Styler attachment without comb

You can use the Beard Styler attachment without the comb to trim and contour your beard, moustache or sideburns.

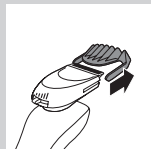

1 Pull the comb off the Beard Styler attachment.

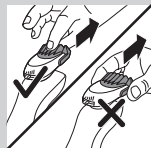

Note: Grab the comb in the centre to pull it off the Beard Styler attachment. Do not pull at the sides of the comb.

2 Press the on/off button to switch on the shaver.

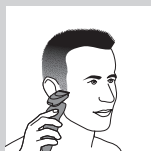

3 You can now start to trim and contour your beard, moustache, sideburns or neckline.

Beard styles

Below you find some examples of beard styles you can create.

- A stubble look

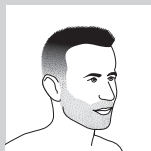

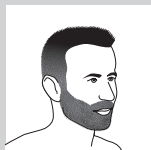

- A full beard

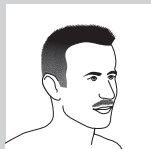

- A moustache

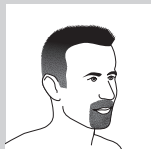

- A goatee

Cleaning and maintenance

Never use scouring pads, abrasive cleaning agents or aggressive liquids such as petrol or acetone to clean the shaver, its accessories and the Jet Clean System (specific types only).

- The best and most hygienic way to clean the shaver is in the Jet Clean System (specific types only). You can also rinse the shaver under the tap or clean it with the brush supplied.
- Clean the shaver after every shave for optimal shaving performance.
- You can clean the outside of the shaver with a damp cloth.
- Regular cleaning guarantees better shaving performance.

Cleaning the shaving unit

Be careful with hot water. Always check if the water is not too hot, to prevent your hands from getting burnt.

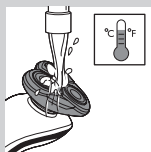

1 Switch off the shaver. Remove it from the charger or remove it from the Jet Clean System (specific types only).

2 Rinse the shaving unit under a hot tap for some time.

Note: You can also clean the shaving unit with the cleaning brush supplied.

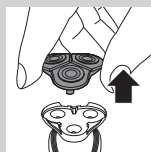

3 Pull the shaving head holder off the bottom part of the shaving unit and rinse it under a hot tap for 30 seconds.

Note: You can also clean the shaving head holder with the cleaning brush supplied.

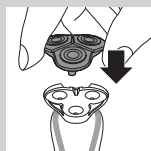

4 Carefully shake off excess water and let the shaving head holder dry.

Never dry the shaving unit with a towel or tissue, as this may damage the shaving heads.

5 Reattach the shaving head holder to the bottom part of the shaving unit ('click').

Cleaning the shaving unit in the Jet Clean System (specific types only)

The Jet Clean System has an automatic cleaning program. When you press the on/off button, the Jet Clean System starts cleaning in this automatic cleaning program.

Preparing the Jet Clean System for use

Fill the cleaning chamber before first use.

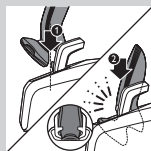
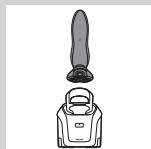
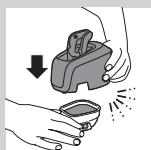
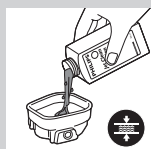
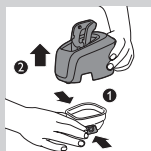

1 Put the small plug in the Jet Clean System.

2 Put the adapter in the wall socket.

► The holder automatically moves to the highest position.

3 Simultaneously press the release buttons on both sides of the cleaning chamber (1). Then lift the Jet Clean System off the cleaning chamber (2).

► The cleaning chamber remains behind.

4 Unscrew the cap from the bottle with HQ200 cleaning fluid.

5 Fill the cleaning chamber with HQ200 cleaning fluid to a level between the two lines.

6 Place the Jet Clean System back onto the cleaning chamber.

Make sure the release buttons click back into place.

Using the Jet Clean System

Note: If you use the shaver with shaving foam or shaving gel, we advise you to rinse it under the hot tap before you clean it in the Jet Clean System. This guarantees an optimal lifetime for the cleaning fluid.

1 Hold the shaver upside down above the holder with the back of the shaver pointing towards the holder.

2 Place the shaver body in the holder behind the two clips (1) and press it down until it locks into place (2).

► The display shows that the shaver is charging (see chapter 'The display').

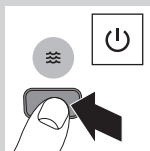

3 Press the on/off button on the Jet Clean System to start the cleaning program.

► The shaver display stops showing the charging indication.

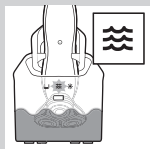

► The cleaning light starts to flash and the shaver is automatically lowered into the cleaning fluid.

► The cleaning light flashes throughout the cleaning program, which takes a few minutes.

► During the first phase of the cleaning program, the shaver automatically switches on and off several times and moves up and down.

► During the second phase of the cleaning program, the shaver is placed in the drying position, indicated by the flashing drying symbol. This phase takes approx. 2 hours. The shaver stays in this position until the end of the program.

► After the cleaning program, the charging indication appears on the shaver display (see chapter 'The display').

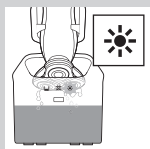

Note: If you press the on/off button of the Jet Clean System during the cleaning program, the program aborts. In this case, the cleaning or drying light stops flashing and the holder moves to the highest position.

Note: If you remove the adapter from the wall socket during the cleaning program, the program aborts. The holder remains in its current position. When you put the adapter back into the wall socket, the holder moves to the highest position.

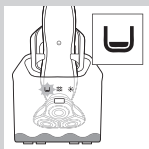

- When the cleaning fluid drops below the minimum level, the 'cleaning chamber empty' symbol starts to flash and the holder returns to its starting position.
- If you use the Jet Clean System to clean your shaver every day, you need to refill the cleaning chamber approx. every 15 days.

Cleaning the Jet Clean System

Clean the cleaning chamber every 15 days.
You can wipe the outside of the Jet Clean System with a damp cloth.

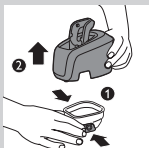

- 1** Simultaneously press the release buttons on both sides of the Jet Clean System (1). Then lift the Jet Clean System off the cleaning chamber (2).

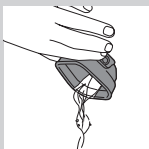

- The cleaning chamber remains behind.

- 2** Pour any remaining cleaning fluid out of the cleaning chamber.

You can simply pour the cleaning fluid down the sink.



- 3** Rinse the cleaning chamber under the tap.

The cleaning chamber is not dishwasher-proof.

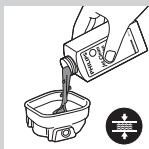

- 4** Fill the cleaning chamber with HQ200 cleaning fluid to a level between the two lines.



- 5** Place the Jet Clean System back onto the cleaning chamber.
Make sure the release buttons click back into place.

Extra-thorough cleaning method

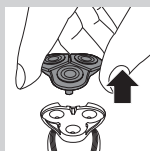

Make sure the appliance is switched off.

- 1** Pull the shaving head holder off the bottom part of the shaving unit.

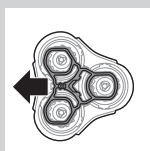

- 2** Slide the green retaining frame in the direction of the arrows indicated on the retaining frame.

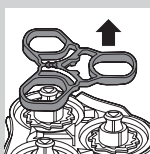

- 3** Lift the retaining frame out of the shaving head holder.

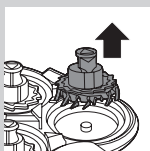

- 4** Remove the cutter from the shaving guard.

Note: Do not clean more than one cutter and shaving guard at a time, since they are all matching sets. If you accidentally put a cutter in the wrong shaving guard, it may take several weeks before optimal shaving performance is restored.

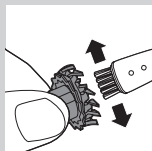

- 5** Clean the cutter with the cleaning brush supplied.

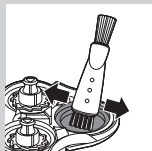

- 6** Clean the inside of the shaving guard.

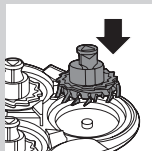

- 7** After cleaning, place the cutter back into the shaving guard with the cutter legs pointing downwards.

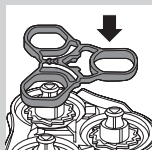

- 8** Place the retaining frame back onto the shaving head holder.

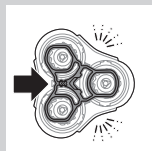

- 9** Slide the guard back into place ('click').

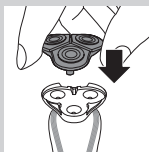

- 10** Reattach the shaving head holder to the bottom part of the shaving unit.

Cleaning the trimmer

Clean the trimmer every time you have used it.

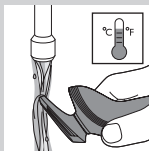

- 1** Switch on the appliance with the trimmer attached.
- 2** Rinse the trimmer under a hot tap for some time.
- 3** After cleaning, switch off the appliance.

Tip: For optimal trimmer performance, lubricate the trimmer teeth with a drop of sewing machine oil every six months.

Cleaning the Beard Styler attachment (specific types only)

Clean the Beard Styler attachment every time you have used it.

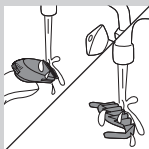

- 1** Pull the comb off the Beard Styler attachment.
- 2** Rinse the Beard Styler attachment and the comb separately under a hot tap for some time.

Note: You can also clean the Beard Styler attachment and the comb with the cleaning brush supplied.

- 3** Lubricate the trimmer teeth with a drop of sewing machine oil every six months.

Storage

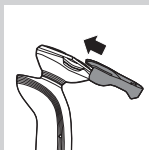

- 1 Slide the protection cap onto the shaving unit to prevent damage to the shaving heads.
- 2 Specific types only: Store the shaver in the pouch supplied.

Replacement

For maximum shaving performance, we advise you to replace the shaving head holder every two years. Only replace the shaving head holder with an original **RQ11 Philips Shaving Head Holder**.

Replacement reminder

To remind you to replace the shaving head holder; the appliance is equipped with a replacement reminder which is activated automatically after approx. two years. The replacement reminder is repeated at 9 successive shaves or until you reset the shaver.

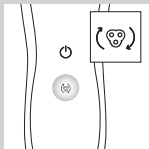

- 1 The shaving unit symbol flashes when you switch off the shaver.

Note: The displays of the various shaver types look different, but show the same symbol.

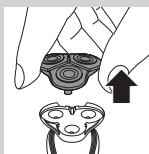

- 2 Pull the shaving head holder off the bottom part of the shaving unit.

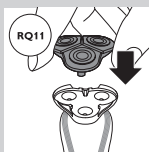

- 3 Attach the new shaving head holder to the bottom part of the shaving unit ('click').

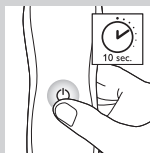

- 4** To reset the shaver, press and hold the on/off button for approx. 10 seconds.

Note: If you do not reset the shaver at the first replacement reminder, it continues to show the shaving unit symbol at 8 more shaves or until you reset the shaver.

Ordering accessories

To purchase accessories for this appliance, please visit our online shop at **www.shop.philips.com/service**. If the online shop is not available in your country, go to your Philips dealer or a Philips service centre. If you have any difficulties obtaining accessories for your appliance, please contact the Philips Consumer Care Centre in your country. You find its contact details in the worldwide guarantee leaflet.

The following parts are available

- HQ8505 adapter
- RQ11 Philips Shaving Head Holder
- HQ110 Philips Shaving Head Cleaning Spray
- HQ200 Philips Cleaning Fluid
- RQ111 Beard Styler attachment

Shaving head holder

- We advise you to replace the shaving head holder every two years. Always replace the shaving head holder with an original RQ11 Philips Shaving Head Holder.

Cleaning

- Specific types only: use Jet Clean Solution (HQ200) for regular cleaning of the shaving heads.



Environment



- Do not throw away the shaver and the Jet Clean System (specific types only) with the normal household waste at the end of their life, but hand them in at an official collection point for recycling. By doing this, you help to preserve the environment.



- The built-in rechargeable shaver battery contains substances that may pollute the environment. Always remove the battery before you discard or hand in the shaver at an official collection point. Dispose of the battery at an official collection point for batteries. If you have trouble removing the battery, you can also take the appliance to a Philips service centre. The staff of this centre will remove the battery for you and will dispose of it in an environmentally safe way.

Removing the rechargeable shaver battery

Only remove the rechargeable battery when you discard the shaver. Make sure the battery is completely empty when you remove it.

Be careful, the battery strips are sharp.

- 1** Remove the back panel of the shaver with a screwdriver.
- 2** Remove the rechargeable battery.

Guarantee and service

If you need service or information or if you have a problem, please visit the Philips website at **www.philips.com/support** or contact the Philips Consumer Care Centre in your country. You find its phone number in the worldwide guarantee leaflet. If there is no Consumer Care Centre in your country, go to your local Philips dealer.

Guarantee restrictions

The shaving heads (cutters and shaving guards) are not covered by the terms of the international guarantee because they are subject to wear.

Troubleshooting

This chapter summarises the most common problems you could encounter with the appliance. If you are unable to solve the problem with the information below, visit www.philips.com/support for a list of frequently asked questions or contact the Consumer Care Centre in your country.

Problem	Possible cause	Solution
The shaver does not shave as well as it used to.	The shaving heads are damaged or worn.	Replace the shaving head holder (see chapter 'Replacement').
	Long hairs obstruct the shaving heads.	Clean the shaving heads by following the steps of the extra-thorough cleaning method (see chapter 'Cleaning and maintenance').

Problem	Possible cause	Solution
	Specific types only: The Jet Clean System has not cleaned the shaver properly, because the cleaning fluid in the cleaning chamber is soiled or the cleaning fluid level is too low.	Clean the shaver thoroughly before you continue shaving. If necessary, clean and refill the cleaning chamber (see chapter 'Cleaning and maintenance').
The shaver does not work when I press the on/off button.	The rechargeable battery is empty.	Recharge the battery (see chapter 'Charging').
	Specific types only: The travel lock is activated.	Press the on/off button for 3 seconds to deactivate the travel lock.
	The shaving head holder is soiled or damaged to such an extent that the motor cannot run.	Clean the shaving head holder or replace it (see chapters 'Cleaning and maintenance' and 'Replacement').
	The temperature of the shaver is too high. In this case, the shaver does not work.	Let the shaver cool down. As soon as the temperature of the shaver has dropped sufficiently, you can switch on the shaver again.

Problem	Possible cause	Solution
Specific types only: The shaver is not entirely clean after I clean it in the Jet Clean System.	The cleaning fluid in the cleaning chamber is soiled.	Empty and rinse the cleaning chamber and refill it with new cleaning fluid.
	The cleaning fluid level is too low. If the fluid volume in the cleaning chamber drops below the minimum level during the cleaning program, the program aborts. The cleaning light and the 'cleaning chamber empty' symbol flash at intervals and the holder returns to its starting position.	Refill the cleaning chamber with cleaning fluid to a level between the two lines (see chapter 'Cleaning and maintenance').
	You have used another cleaning fluid than the original Philips cleaning fluid.	Only use HQ200 Philips Cleaning Fluid.
Specific types only: The Jet Clean System does not work when I press the on/off button.	The Jet Clean System is not connected to the mains.	Put the small plug in the Jet Clean System and put the adapter in the wall socket.

34 ENGLISH

Problem	Possible cause	Solution
	There is no electrical connection between the Jet Clean System and the shaver.	Press the shaver tightly into the holder to lock it into place.
The shaver is not fully charged after I charge it in the charger/Jet Clean System (specific types only).	You have not placed the shaver in the charger/Jet Clean System (specific types only) properly.	Make sure you press the shaver until it locks into place.

简介

感谢您的惠顾，欢迎光临飞利浦！为了您能充分享受飞利浦提供的支持，请在 www.philips.com/welcome 上注册您的产品。请阅读本用户手册，手册包含有关此剃须刀各种功能的信息以及一些使用技巧，让您的剃须体验更轻松更舒适。

一般说明 (图 1)

- A 剃须刀
 - 1 显示屏
 - 2 剃须刀开/关按钮
 - 3 保护盖
 - 4 RQ11 剃须刀头部件
- B CRP331 修剪器（仅限于 RQ118x/RQ116x/RQ115x）
- C RQ111 胡须造型器附件（仅限于 RQ1195/RQ1185/RQ1175）
 - 1 须发长度选择器
 - 2 胡须造型器附件的修剪梳
- D Jet Clean 高效能清洁系统（仅限于 RQ1195CC/RQ1185CC/RQ1180CC/RQ1175CC）
 - 1 剃须刀支架
 - 2 “清洗仓已空”符号
 - 3 清洁符号
 - 4 干燥符号
 - 5 Jet Clean 高效能清洁系统开/关按钮
 - 6 清洗仓释放按钮
- E 适配器
- F 充电器
- G 清洁刷
- H HQ200 清洁剂（仅限于特定型号）
- I 精美软袋（仅限于特定型号）

注意事项

使用剃须刀和 Jet Clean 高效能清洁系统之前，请仔细阅读本用户手册，并妥善保管以供日后参考。

注意：在本用户手册中，术语“产品”指剃须刀和 Jet Clean 高效能清洁系统。如果您的剃须刀不随附 Jet Clean 高效能清洁系统，则它专指剃须刀。

概述



危险

- 确保电源适配器干燥。

警告

- 警告符号注释：禁止用在打开的水龙头下进行清洗。
- 电源适配器内含有一个变压器。切勿将其剪断，而用另一个插头代替，否则将导致严重后果。
- 电源软线不能更换，如果软线损坏，此器具（电源适配器）应废弃。
- 本产品不打算由肢体不健全、感觉或精神上有障碍或缺乏相关经验和知识的人（包括儿童）使用，除非有负责他们安全的人员对他们使用这些产品进行监督或指导。
- 应照看好儿童，确保他们不会玩耍剃须刀和 Jet Clean 高效能清洁系统。
- 清洁产品时要小心使用热水。切记先检查水温是否太高，以防手被烫伤。
- 警告：将手持部分与电源软线分开后，才能在水中清洗手持部分。

注意

- 切勿将 Jet Clean 高效能清洁系统和充电器浸入水中，也不要放在水龙头下冲洗。
- 产品和附件不可用洗碗机清洗。
- 一定要在抗有机溶剂腐蚀的表面上放置和使用本产品。
- 必须在 5° C 至 35° C 之间的温度下使用、存放和为剃须刀充电。
- 仅使用本剃须刀随附的附件或专为本剃须刀设计的附件。
- 如果适配器或任何其他附件损坏，必须用原装型号更换，以免发生危险。
- 电源适配器可将 100-240 伏的电压转换为 24 伏以下的安全低电压。
- 如果产品损坏，请勿使用本产品和附件。
- 冲洗产品时，水可能从剃须刀底部的插口漏出。这是正常的，而且没有危险，因为所有的电子线路都密封在剃须刀内的一个密封壳内。

Jet Clean 高效能清洁系统（仅限于特定型号）**注意**

- Jet Clean 高效能清洁系统只能使用原装 HQ200 清洁剂。
- Jet Clean 高效能清洁系统必须放在稳定、平坦的抗有机溶剂腐蚀的水平表面上，以防漏液。
- 切勿将 Jet Clean 高效能清洁系统浸入水中。
- 每 15 天倒空清洗仓一次，并用热水彻底冲洗。
- Jet Clean 高效能清洁系统能彻底清洗您的剃须刀，但不能消毒；因此切勿与他人共用剃须刀。
- Jet Clean 高效能清洁系统的清洗仓不可在洗碗机中清洗。
- 当 Jet Clean 高效能清洁系统准备就绪时，切勿移动本产品，以免清洁剂漏出。

胡须造型器附件（仅限于特定型号）

注意

- 仅使用胡须造型器附件修剪面部须发（胡须、须髥和鬓角）。请勿将其用于修剪领口以下的身体部位。
- 仅将胡须造型器附件与以下型号的剃须刀结合使用：RQ12xx、RQ11xx、RQ10xx。
- 胡须造型器附件不能用洗碗机清洗。

符合标准



- 此剃须刀符合国际认可的安全标准，可在洗澡或淋浴时安全地使用，并可在水龙头下清洗。
- 符号注释：适合于在洗澡或淋浴时使用。允许在盛水的浴缸、淋浴、洗脸盆或其他器皿附近使用本器具。
- 这些飞利浦产品符合关于电磁场 (EMF) 的所有相关标准。据目前的科学证明，如果正确使用并按照本用户手册中的说明进行操作，本产品是安全的。

显示屏

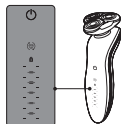

注意： 如果显示屏上有保护膜，首次使用剃须刀时，请将其取下。

不同型号的剃须刀具有不同的显示屏，具体如下图所示。

- RQ1195/RQ1180/RQ1175

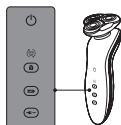

- RQ1185/RQ1160

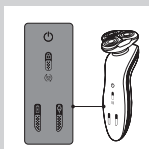

- RQ1155/RQ1151/RQ1150/RQ1145/RQ1141/
RQ1131

充电

- 充电约需 1小时。

RQ1195/RQ1180/RQ1175

- 剃须刀充电时，底部的第一个充电指示灯会先闪烁，接着第二个充电指示灯闪烁，以此类推，直到剃须刀完全充满电。
- 快速充电：当剃须刀包含的电量仍够剃须一次时，底部的充电指示灯会交替闪烁橙色和白色。

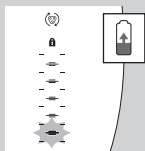

RQ1185/RQ1160/RQ115x/RQ114x/RQ113x

注意：不同型号的剃须刀显示屏外观不同。但工作原理是一样的。

- 剃须刀充电时，插头符号和电池符号先交替闪烁。一段时间后，插头符号熄灭，电池符号持续闪烁直至剃须刀完全充满电。
- 快速充电：当剃须刀包含的电量仍够剃须一次时，插头符号和电池符号将停止交替闪烁，仅电池符号闪烁。

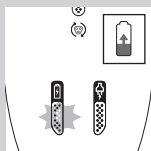

电池已完全充满

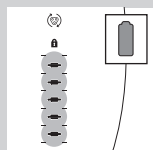

RQ1195/RQ1180/RQ1175

- 当电池完全充满电时，所有充电指示灯均会持续亮起。大约 30 分钟后，显示屏会再次自动关闭。

RQ1185/RQ1160/RQ115x/RQ114x/RQ113x

注意：不同型号的剃须刀显示屏外观不同。但工作原理是一样的。

- 当电池完全充满电时，电池符号会持续亮起。大约 30 分钟后，显示屏会再次自动关闭。

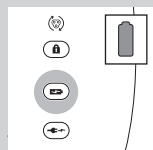

电池电量不足

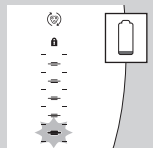

RQ1195/RQ1180/RQ1175

- 当电池电量快要耗尽时（仅剩 5 分钟或更少的剃须时间），底部的充电指示灯将闪烁橙色。
- 关闭剃须刀时，底部的充电指示灯将持续闪烁几秒钟。

RQ1185/RQ1160/RQ115x/RQ114x/RQ113x

注意：不同型号的剃须刀显示屏外观不同。但工作原理是一样的。

- 当电池电量快要耗尽时（仅剩 5 分钟或更少的剃须时间），插头符号将会闪烁。
- 关闭剃须刀时，插头符号将持续闪烁几秒钟。

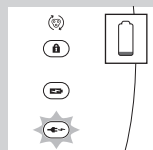

电池剩余电量

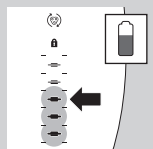

RQ1195/RQ1180/RQ1175

- 剩余的电池电量由亮起的充电指示灯数来表示。

旅行锁

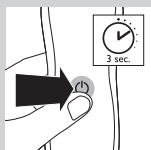

您可以在携带剃须刀旅行之前将其锁住。旅行锁可防止剃须刀被意外打开。

启用旅行锁

1 按住开/关按钮 3 秒钟以进入旅行锁模式。

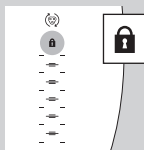

锁符号将在显示屏上亮起。

注意：不同型号的剃须刀显示屏外观不同。但显示相同的符号。

解除旅行锁

1 按开/关按钮 3 秒钟。

马达开始运行即表示旅行锁已解除。现在可以重新开始使用剃须刀。

注意：当您将剃须刀插接到充电器或放到 Jet Clean 高效能清洁系统中时，旅行锁将自动解除。

更换剃须刀头支架

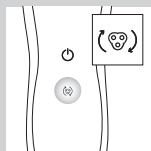

注意：不同型号的剃须刀显示屏外观不同。但显示相同的符号。

为获得最佳剃须效果，建议每两年更换一次剃须刀头支架。

为了提醒您更换剃须刀头部件，产品配备了更换提醒，该提醒在约两年后自动激活。更换提醒会在连续剃须 9 次后或直至您重置剃须刀前重复。

充电

充电约需 1 小时。

RQ1195/RQ1185/RQ1180/RQ1175/RQ1160/
RQ1155: 完全充电的剃须刀剃须时间可长达
50 分钟或 15 天。

RQ1151/RQ1150/RQ1145: 完全充电的剃须刀
剃须时间可长达 45 分钟或 13 天。

RQ1141/RQ1131: 完全充电的剃须刀剃须时间
可长达 40 分钟或 12 天。

第一次使用剃须刀之前, 或当显示屏指示电池电
量快要耗尽时, 请先为剃须刀充电 (参见“显示
屏”一章中的“电池电量不足”部分的内容)。

快速充电

剃须刀在充电 5 分钟后, 其含有的电量便足以
完成一次剃须。

在充电器中充电

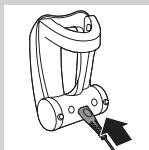

1 将小插头插入充电器。



2 展开充电器 (可听到“咔哒”一声)。

3 将电源适配器插入电源插座。

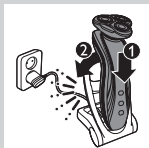

4 将剃须刀插接到充电器中 (1) 然后将其向后
按, 直到其锁定到位 (2)。

► 显示屏将显示剃须刀正在充电 (参见“显示
屏”一章中的“充电”部分的内容)。

在 Jet Clean 高效能清洁系统中充电（仅限于特定型号）

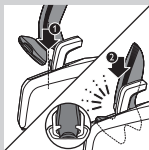
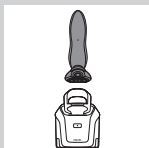

- 1** 将小插头插入 Jet Clean 高效能清洁系统。
- 2** 将电源适配器插入电源插座。
- 3** 将剃须刀倒置按在支架上，使剃须刀的背面向向支架。

注意：RQ1195/RQ1180/RQ1175：将剃须刀倒置时，显示屏上的电池指示也会倒置，因此您仍然能够看清电池充电的情况。

- 4** 将剃须刀机身放在两个固定夹后的支架中 (1) 并将其按下，直到其锁定到位 (2)。

注意：当剃须刀头部件上套了保护盖，或剃须刀上装了修发器时，不可将剃须刀放到 Jet Clean 高效能清洁系统中。

- ▶ 显示屏将显示剃须刀正在充电（见“显示屏”一章）。

使用剃须刀

剃毛

皮肤适应期

前几次剃须可能不会带给您预期效果，并且您的皮肤可能会受到轻度刺激。这是正常的。您的皮肤和胡须需要时间适应新的剃须系统。建议您在 3 周内定期剃须（至少每周 3 次），以便让您的皮肤适应新的剃须刀。在此期间，请仅使用新的电动剃须刀，不要使用其他剃须方法。如果您使用不同的剃须方法，那么您的皮肤会更难适应新的剃须系统。



1 按一下开/关按钮以启动剃须刀。
RQ1195/RQ1180/RQ1175: 显示屏将亮起几秒钟的时间。

2 将剃须刀头在您的皮肤上作迂回运动。
- 请勿作直线运动。

3 按一下开/关按钮关闭剃须刀电源。
RQ1195/RQ1180/RQ1175: 显示屏将亮起几秒钟时间, 然后显示电池剩余电量。

湿剃

您也可以先用剃须泡沫或剃须啫喱将脸弄湿, 然后再用此剃须刀进行剃须。
要用剃须泡沫或剃须啫喱剃须, 请按照下面的步骤执行操作:

1 用水润湿一下皮肤。

2 在皮肤上涂上剃须泡沫或剃须啫喱。

3 在水龙头上冲洗一下剃须刀头部件, 确保剃须刀头部件可以在您的皮肤上顺畅滑动。

4 按一下开/关按钮以启动剃须刀。

5 将剃须刀头在您的皮肤上作迂回运动。

注意: 在水龙头下定期冲洗剃须刀, 确保其能够继续在您的皮肤上顺畅滑动。

6 使用后, 擦干您的脸并彻底清洁剃须刀
(见“清洁和保养”一章)。

注意: 确保冲洗干净剃须刀上的泡沫或剃须啫喱。

使用修剪器（仅限于特定型号）

您可使用修剪器修剪鬓角和小胡子。

- 1 将剃须刀头部件竖直抽离剃须刀。

注意：将其抽离剃须刀时，不要旋转剃须刀头部件。

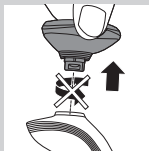

- 2 将修剪器的凸缘插入剃须刀顶部的槽内 (1)。然后按下修剪器 (2) 以将其安装在剃须刀上（可听到“咔哒”一声）。



- 3 按一下开/关按钮打开修发器。

► RQ1180：显示屏将亮起几秒钟的时间。

- 4 现在可以开始修剪了。

- 5 按一下开/关按钮关闭修发器。

► RQ1180：显示屏将亮起几秒钟时间，以显示电池剩余电量。

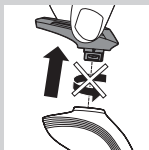

- 6 将修发器竖直抽离剃须刀。

注意：将其抽离剃须刀时，不要旋转修剪部件。



- 7 将剃须刀头部件的凸缘插入剃须刀顶部的槽内 (1)。然后按下剃须刀头部件 (2) 以将其安装在剃须刀上（可听到“咔哒”一声）。

使用胡须造型器附件（仅限于特定型号）

注意：仅使用胡须造型器附件修剪面部须发（胡须、须髥和鬓角）。请勿将其用于修剪领口以下的身体部位。

- 1** 确保剃须刀已关闭。
- 2** 将剃须刀头部件竖直抽离剃须刀。

注意：将其抽离剃须刀时，不要旋转剃须刀头部件。

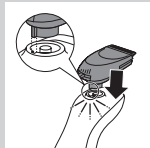
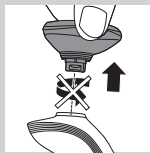

- 3** 将胡须造型器附件的凸缘插入剃须刀顶部的槽内 (1)。然后按下胡须造型器附件 (2) 以将其安装在剃须刀上（可听到“咔哒”一声）。

使用带修剪梳的胡须造型器附件

您可以使用带修剪梳的胡须造型器附件以固定设置（也可使用不同的长度设置）修整胡须。胡须造型器附件的须发长度设置对应修剪后剩余的须发长度，范围为 1 到 5 毫米。

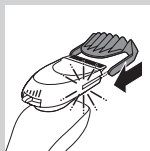

- 1** 将修剪梳直接滑入胡须造型器附件两侧的导槽中（可听到“咔哒”一声）。

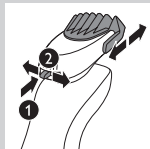

- 2** 按下长度选择器 (1)，然后将其向左或向右推动 (2) 以选择所需的须发长度设置。

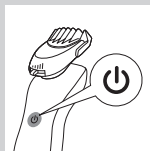

- 3** 按下剃须刀上的开/关按钮将其打开。

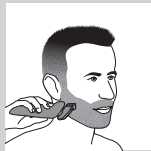

4 您现在可以开始修整胡须。

使用不带修剪梳的胡须造型器附件

您可以使用不带修剪梳的胡须造型器附件修剪和修整胡须、须髥或鬓角的轮廓。

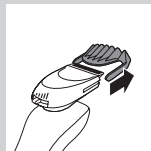

1 将修剪梳抽离胡须造型器附件。

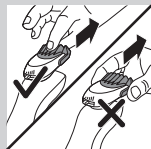

注意：抓住修剪梳的中心位置，将其抽离胡须造型器附件。请勿拉拔修剪梳的侧面。

2 按下开/关按钮启动剃须刀。



3 您现在可以开始修剪和修整胡须、须髥、鬓角或颈部的轮廓。

胡须造型

您可以在下面找到您可塑造的胡须造型的一些示例。

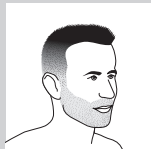

- 胡茬造型

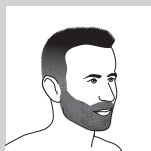

- 大胡子

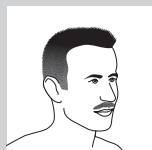

- 须髥

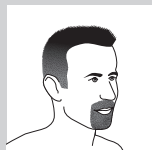

- 山羊胡

清洁和保养

切勿使用钢丝绒、研磨性清洁剂或腐蚀性液体（例如汽油或丙酮）来清洁剃须刀、剃须刀附件和 **Jet Clean** 高效能清洁系统（仅限于特定型号）。

- 在 **Jet Clean** 高效能清洁系统（仅限于特定型号）中清洁剃须刀是最有效、最卫生的方法。您还可以在水龙头下冲洗剃须刀或用随附的毛刷进行清洁。
- 每次剃须后清洁剃须刀，以获得最佳的剃须性能。
- 可以用湿布清洁剃须刀的外侧。
- 为保证更好的剃须效果，剃须刀必须定期清洗。

清洁剃毛刀头部件

使用热水时一定要小心。切记先检查水温是否太高，以防烫手。

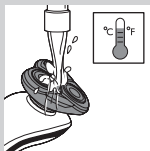

1 关闭剃须刀。将其从充电器中拔出，或从 Jet Clean 高效能清洁系统中拔出（仅限于特定型号）。

2 在热水龙头下冲洗一会儿剃须刀头部件。

注意：您也可以使用随附的清洁刷清洁剃须刀头部件。

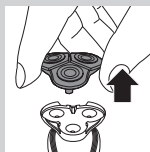

3 将剃须刀头支架抽离剃须刀头部件的底部，然后在热水龙头下冲洗 30 秒。

注意：您也可以使用随附的清洁刷清洁剃须刀头支架。

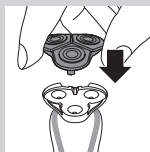

4 小心甩干多余的水，然后使剃须刀头支架干燥。

不要用手巾或纸巾擦拭剃须刀头部件，因为这样可能会损坏剃须刀头。

5 将剃须刀头支架重新装回剃须刀头部件的底部（可听到“咔哒”一声）。

在 Jet Clean 高效能清洁系统中清洁剃须刀头部件（仅限于特定型号）

Jet Clean 高效能清洁系统具有一个自动清洗程序。按下开/关按钮时，Jet Clean 高效能清洁系统将开始以此自动清洗程序清洁。

Jet Clean 高效能清洁系统使用准备

首次使用之前请将清洁剂注满清洗仓。

1 将小插头插入 Jet Clean 高效能清洁系统。

2 将电源适配器插入电源插座。

，支架将自动移到最高位置。

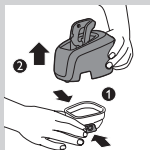

3 同时按下清洗仓两侧的释放钮 (1)。然后将 Jet Clean 高效能清洁系统从清洗仓上提起 (2)。

► 留下清洗仓。

4 拧开装 HQ200 清洁剂的瓶子的瓶盖。

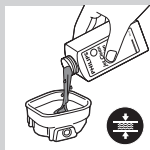

5 给清洗仓注入 HQ200 清洁剂，水量在两线之间为宜。

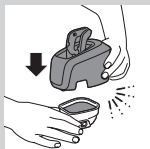

6 将 Jet Clean 高效能清洁系统重新放在清洗仓上。
确保释放键卡回到位。

使用 Jet Clean 高效能清洁系统

注意：如果您在剃须时使用了剃须泡沫或剃须喱，建议您在将剃须刀放入 Jet Clean 高效能清洁系统清洁之前，先在热水龙头下冲洗干净。这样可以保证清洁剂拥有最佳的使用寿命。



1 将剃须刀倒置按在支架上，使剃须刀的背面向向支架。

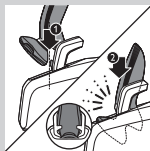

2 将剃须刀机身放在两个固定夹后的支架中 (1) 并将其按下，直到其锁定到位 (2)。显示屏将显示剃须刀正在充电（见“显示屏”一章）。

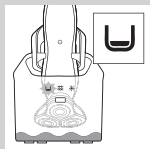
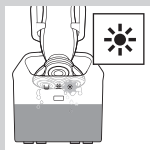
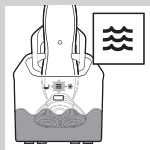
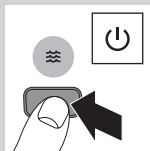

3 按 Jet Clean 高效能清洁系统上的开/关按钮以启动清洁程序。

剃须刀显示屏停止显示充电指示。

清洗指示灯开始闪烁，剃须刀将自动降到清洁剂中。

清洗指示灯在整个清洗程序中不断闪烁，这需要几分钟时间。

在清洗程序的第一个阶段，剃须刀将开关数次，并会向上和向下移动。

在清洗程序的第二个阶段，剃须刀处在干燥档位，这由一个闪烁的干燥符号表示。此阶段大约需要 2 小时。在此程序结束之前剃须刀一直都会处在此档位。

清洗程序结束后，充电指示将出现在剃须刀显示屏上（见“显示屏”一章）。

注意：如果在清洗程序运行期间按 Jet Clean 高效能清洁系统的开/关按钮，则程序将中断。此时，清洗或干燥指示灯将停止闪烁，支架将回到最高位置。

注意：如果在清洗程序运行期间将适配器从插座上拔除，则程序将中断。支架将保持在当前位置不变。当您适配器重新插入插座时，支架将继续移动到最高的位置。

- 当清洁剂水位下降至最低水位以下时，“清洗仓已空”符号将开始闪烁，支架将返回到起始位置。

- 如果每天都使用 Jet Clean 高效能清洁系统清洗您的剃须刀，则需要大约每 15 天向清洗仓内补充清洁剂一次。

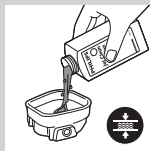
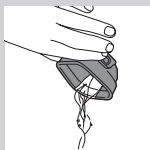
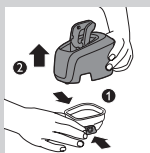

清洁 Jet Clean 高效能清洁系统

每隔 15 天清洁一次清洗仓。

您可以用湿布擦拭 Jet Clean 高效能清洁系统的外表面。

1 同时按下 Jet Clean 高效能清洁系统两侧的释放钮 (1)。然后将 Jet Clean 高效能清洁系统从清洗仓上提起 (2)。

2 留下清洗仓。

2 将清洗仓中残余的清洁剂倒出。
您只需将清洁剂倒入水槽。

3 在水龙头下冲洗清洗仓。

清洗仓不可在洗碗机中清洗。

4 给清洗仓注入 HQ200 清洁剂，注入量在两线之间为宜。

5 将 Jet Clean 高效能清洁系统重新放在清洗仓上。

确保释放键卡回到位。

超彻底清洁方法

确保产品电源已关闭。

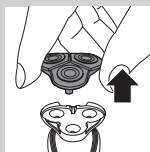

- 1 将剃须刀头支架从剃须刀头部件的底部抽离。

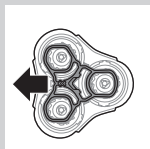

- 2 按固定架所示的箭头方向滑动绿色固定架。

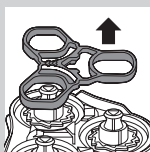

- 3 将固定架从剃须刀头支架中提起并取出。

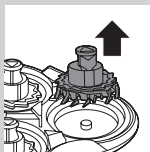

- 4 将刀片从网罩上取下。

注意：不要同时清洁多组刀片和网罩，因为它们都是相互匹配的。如果不小心将刀片装到了错误的网罩上，则需要数周时间才能恢复产品的最佳剃须性能。

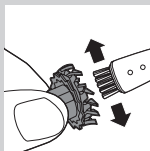

- 5 用随附的清洁刷清洁刀片。

54 简体中文

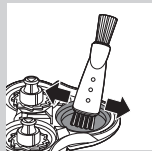

6 清洁网罩的内侧。

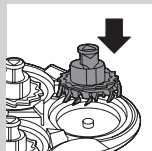

7 清洁后，将刀片重新装回至网罩，刀片底部朝下。

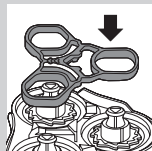

8 装固定架装回到剃须刀头支架上。

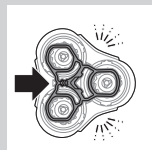

9 将网罩滑回到位（可听到“咔哒”一声）。

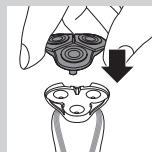

10 将剃须刀头支架重新装回剃须刀头部件的底部。

清洁修发器

每次使用后都要清洁修剪器。

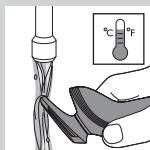

- 1** 打开装有修剪器的产品。
- 2** 在热水龙头下冲洗一会儿修发器。
- 3** 清洁完成后，关闭产品。

提示：为获得最佳修剪性能，每六个月用一滴缝纫机油润滑修发器齿。

清洁胡须造型器附件（仅限于特定型号）

每次使用后，请清洁胡须造型器附件。

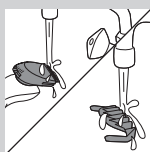

- 1** 将修剪梳抽离胡须造型器附件。
- 2** 在热水龙头下单独冲洗胡须造型器附件和修剪梳片刻。

注意：您也可以用随附的清洁刷清洁胡须造型器附件和修剪梳。

- 3** 每六个月用一滴缝纫机油润滑修发器齿。

存储

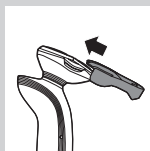

- 1** 将保护盖滑动到剃须刀头部件上，以防损坏剃须刀头。
- 2** 仅限于特定型号：用随附的精美软袋存放剃须刀。

更换

为获得最佳剃须效果，建议每两年更换一次剃须刀头支架。

仅使用原装 **RQ11** 飞利浦剃须刀头支架更换剃须刀头支架。

更换提醒

为了提醒您更换剃须刀头部件，产品配备了更换提醒，该提醒在约两年后自动激活。更换提醒会在连续剃须 9 次后或直至您重置剃须刀前重复。

1 关闭剃须刀后，剃须刀头部件符号闪烁。

注意：不同型号的剃须刀显示屏外观不同。但显示相同的符号。

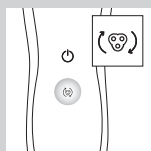

2 将剃须刀头支架从剃须刀头部件的底部抽离。

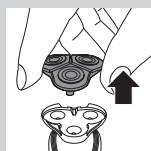

3 将新的剃须刀头支架装回剃须刀头部件的底部（可听到“咔哒”一声）。

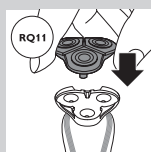

4 要重置剃须刀，按住开/关按钮约 10 秒钟。

注意：如果在首次更换提醒后您未重置剃须刀，连续剃须 8 次后或直至您重置剃须刀前，它将持续显示剃须刀头部件符号。

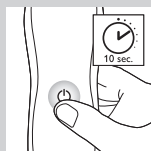

订购附件

要购买本产品的附件，请访问我们的在线商城 www.shop.philips.com/service。如果您的国家/地区没有在线商城，请联系您的飞利浦经销商或飞利浦服务中心。如果您在购买产品的附件时遇到困难，请联系您所在国家/地区的飞利浦客户服务中心。可在全球保修卡中找到其详细联系信息。

可选配以下附件

- HQ8505 适配器
- RQ11 飞利浦剃须刀头支架
- HQ110 飞利浦剃须刀头清洁喷雾剂
- HQ200 飞利浦高效能清洁剂
- RQ111 胡须造型器附件

剃须刀头支架

- 建议您每两年更换一次剃须刀头支架。务必使用原装 RQ11 飞利浦剃须刀头支架进行更换。

清洁

- 仅限于特定型号：使用喷雾清洁溶液 (HQ200) 定期清洁剃须刀头。



环保



- 弃置剃须刀和 Jet Clean 高效能清洁系统（仅限于特定型号）时，请不要将其与一般生活垃圾堆放在一起；应将其交给官方指定的回收中心。这样做有利于环保。



- 内置充电电池含有可能会污染环境的物质。丢弃剃须刀时，一定要将电池取出，或将剃须刀送到官方指定的回收站。到官方指定的电池回收站处理电池。如果您在取出电池时遇到问题，您也可以将剃须刀送至飞利浦维修中心。维修中心的员工会帮您取出电池，并以环保的方式处理它。

卸下剃须刀的充电电池

只有在丢弃剃须刀时才可取下充电电池。请确保在取下电池时电量已完全耗尽。

注意，电池带非常锋利。

- 1 使用螺丝刀卸下剃须刀的背部面板。
- 2 卸下充电电池。

保修与服务

如果您需要服务或信息，或者有任何疑问，请访问飞利浦网站：www.philips.com/support。您也可与您所在国家/地区的飞利浦客户服务中心联系（可从全球保修卡中找到其电话号码）。如果您所在的国家/地区没有飞利浦客户服务中心，请与当地的飞利浦经销商联系。

保修条款

由于剃须刀头（刀片和网罩）属于易磨损物品，因此不在国际保修条款的涵盖范围之列。

故障种类和处理方法

本章归纳了使用本产品时最常见的一些问题。如果您无法根据以下信息解决问题，请访问www.philips.com/support 查阅常见问题列表，或联系您所在国家/地区的客户服务中心。

问题	可能的原因	解决方法
剃须刀的剃须效果没有以前好。	剃须刀头已损坏或磨损。	更换剃须刀头支架（见“更换”一章）。
	过长的胡须堵塞了剃须刀头。	通过执行下列彻底清洁方法中的步骤来清洁剃须刀头（见“清洁和保养”一章）。
	仅限于特定型号：由于清洗仓内的清洁剂可能受到污染或清洁剂水位太低，Jet Clean 高效能清洁系统可能无法正常清洗剃须刀。	在继续剃须之前，请先彻底清洁剃须刀。如有必要，请清洁清洗仓并为其重新注入清洁剂（见“清洁和保养”一章）。
按下开/关按钮时，剃须刀不工作。	充电电池的电量已耗尽。	给电池充电（见“充电”一章）。
	仅限于特定型号：旅行锁已被激活。	按住开/关按钮 3 秒钟以禁用旅行锁。
	剃须刀头支架被污染或损坏，导致马达无法运行。	清洁剃须刀头支架或进行更换（见“清洁和保养”及“更换”章节）。
	剃须刀的温度过高。此时，剃须刀无法工作。	让剃须刀冷却。一旦剃须刀降到足够低的温度，便可重新打开剃须刀。

60 简体中文

问题	可能的原因	解决方法
仅限于特定型号：剃须刀放在 Jet Clean 高效能清洁系统中清洁之后依然没有完全干净。	清洗仓内的清洁剂可能被污染。	将清洗仓倒空并用水冲洗，然后再加入新清洁剂。
	清洁剂水位过低。如果在清洗程序运行期间清洗仓中的液体容量降到了最低水位以下，程序将中断。清洗指示灯和“清洗仓已空”符号将开始间歇性闪烁，支架将恢复至最初的位置。	给清洗仓重新注入清洁剂，水位在两线之间为宜（见“清洁和保养”一章）。
	您使用了其他清洁剂，而不是原装飞利浦清洁剂。	仅可使用 HQ200 飞利浦清洁剂。
仅限于特定型号：按下开/关按钮时，Jet Clean 高效能清洁系统不工作。	Jet Clean 高效能清洁系统未通电。	将小插头插入 Jet Clean 高效能清洁系统，然后将电源适配器插入电源插座。

问题	可能的原因	解决方法
	Jet Clean 高效能清洁系统和剃须刀之间未通电。	将剃须刀牢固地按入支架，使其锁定到位。
剃须刀在充电器/Jet Clean 高效能清洁系统（仅限于特定型号）中无法充满电。	剃须刀在充电器/Jet Clean 高效能清洁系统（仅限于特定型号）中插接不正确。	确保您按下剃须刀，直到其锁定到位。

62 简体中文

PHILIPS

产品 : 飞利浦电动剃须刀
型号 : RQ1195CC
额定电压 : 220V~
额定频率 : 50Hz
额定输入功率: 9W
生产日期 : 请见产品本体
产地 : 荷兰



制造商: 飞利浦电子香港有限公司
香港新界沙田香港科学园科技道东五号

经销单位: 飞利浦(中国)投资有限公司
上海市天目西路218号1602-1605
全国顾客服务热线: 4008 800 008

本产品根据国标 GB4706.1-2005, GB4706.9-2008
制造

PHILIPS

产品 : 飞利浦电动剃须刀
型号 : RQ1180
额定电压 : 220V~
额定频率 : 50Hz
额定输入功率: 9 W
生产日期 : 请见产品机身
产地 : 荷兰



飞利浦电子香港有限公司
香港新界沙田香港科学园科技道东五号
全国顾客服务热线: 4008 800 008

本产品根据国标 GB4706.1-2005, GB4706.9-2008
制造

PHILIPS

产品 : 飞利浦电动剃须刀
型号 : RQ1175
额定电压 : 220V~
额定频率 : 50Hz
额定输入功率: 9W
生产日期 : 请见产品本体
产地 : 荷兰



制造商: 飞利浦电子香港有限公司
香港新界沙田香港科学园科技道东五号

经销单位: 飞利浦(中国)投资有限公司
上海市天目西路218号1602-1605
全国顾客服务热线: 4008 800 008

本产品根据国标 GB4706.1-2005, GB4706.9-2008
制造

PHILIPS

产品 : 飞利浦电动剃须刀
型号 : RQ1160CC
额定电压 : 220V~
额定频率 : 50Hz
额定输入功率: 9 W
生产日期 : 请见产品机身
产地 : 荷兰



飞利浦电子香港有限公司
香港新界沙田香港科学园科技道东五号
全国顾客服务热线: 4008 800 008

本产品根据国标 GB4706.1-2005, GB4706.9-2008
制造

PHILIPS

产品 : 飞利浦电动剃须刀
 型号 : RQ1160
 额定电压 : 220V~
 额定频率 : 50Hz
 额定输入功率: 9 W
 生产日期 : 请见产品机身
 产地 : 荷兰



飞利浦电子香港有限公司
 香港新界沙田香港科学园科技道东五号
 全国顾客服务热线: 4008 800 008

本产品根据国标 GB4706.1-2005, GB4706.9-2008
 制造

PHILIPS

产品 : 飞利浦电动剃须刀
 型号 : RQ1150
 额定电压 : 220V~
 额定频率 : 50Hz
 额定输入功率: 9 W
 生产日期 : 请见产品机身
 产地 : 荷兰



飞利浦电子香港有限公司
 香港新界沙田香港科学园科技道东五号
 全国顾客服务热线: 4008 800 008

本产品根据国标 GB4706.1-2005, GB4706.9-2008
 制造

PHILIPS

产品 : 飞利浦电动剃须刀
 型号 : RQ1131
 额定电压 : 220V~
 额定频率 : 50Hz
 额定输入功率: 9W
 生产日期 : 请见产品本体
 产地 : 荷兰



制造商: 飞利浦电子香港有限公司
 香港新界沙田香港科学园科技道东五号

经销单位: 飞利浦 (中国) 投资有限公司
 上海市天目西路218号1602-1605
 全国顾客服务热线: 4008 800 008

本产品根据国标 GB4706.1-2005, GB4706.9-2008
 制造







www.philips.com



100% recycled paper
100% papier recyclé
100% 循环再造纸

4222.002.5349.2